

# HDI 302

## IR Audio Transmission Technology | Receivers

### General Description

The HDI 302 is a professional two-channel stethoset receiver for the carrier frequencies 2.3 and 2.8 MHz. It can be switched between operation on channel 1, 2 or stereo and features outstanding speech intelligibility and very good music reproduction. It is powered by the environmentally friendly BA 151 accupack. Also available is the RI 300, a pure stereo receiver.



### Technical Data

Modulation ..... wideband FM, stereo  
 Carrier frequencies ..... 2.3 and 2.8 MHz  
 AF frequency response ..... 18 – 18,000 Hz  
 THD ..... < 1%  
 Signal-to-noise ratio ..... typ. 64 dB  
 Max. SPL ..... approx. 110 dB  
 Operating time ..... approx. 5 hrs  
 Weight ..... approx. 45 g (including accupack)

### Features

- Wideband stethoset receiver for stereo and two-channel applications (HDI 302 only)
- Excellent transmission reliability due to carrier frequencies 2.3 and 2.8 MHz
- High speech intelligibility and very good stereo music reproduction
- Very easy to use
- Powered by environmentally friendly NiMH accupack
- Delivery includes:  
 HDI 302: 1 x HDI 302 two-channel stethoset receiver, 1 x BA 151 accupack  
 RI 300: 1 x RI 300 stereo stethoset receiver, 1 x BA 151 accupack

### Recommended Accessories

- BA 151 accupack Cat. No. 004146
- Charger for two BA 151
  - L 151-2 European version Cat. No. 004457
  - L 151-2-120 USA version Cat. No. 004459
  - L 151-2-UK UK version Cat. No. 004458
- L 151-10 charging unit for 10 receivers Cat. No. 004494
- Plug-in mains unit for one L 151-10
  - NT 92 European version Cat. No. 003357
  - NT 92-120 USA version Cat. No. 003358
  - NT 92-UK UK version Cat. No. 003359
- Plug-in mains unit for two to five L 151-10
  - NT 2013 European version Cat. No. 003433
  - NT 2013-120 USA version Cat. No. 003434
  - NG 2013-UK UK version Cat. No. 054332
- Replacement earpads, black, firmer version Spare Part No. 037080
- Replacement earpads, transparent, softer version Spare Part No. 040949

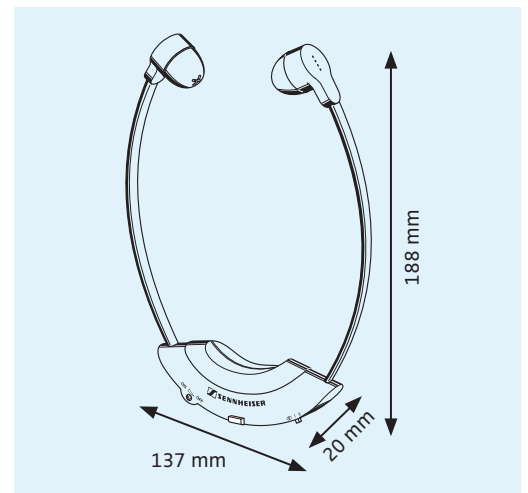

Dimensions of the HDI 302

### Product Variants

- HDI 302: 2-channel stethoset receiver Cat. No. 004392
- RI 300: Stereo stethoset receiver Cat. No. 004378

# HDI 302

## IR Audio Transmission Technology | Receivers

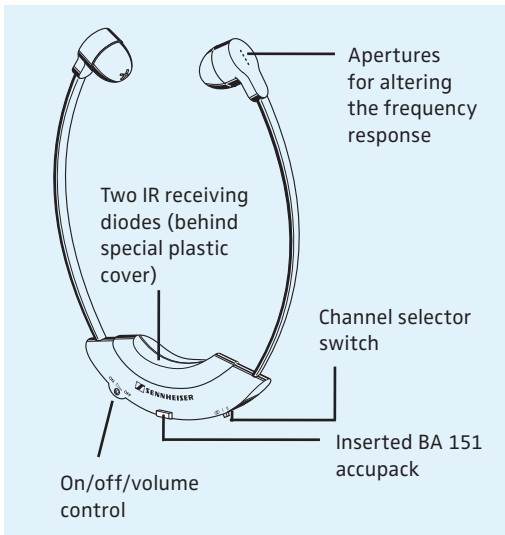

HDI 302 two-channel stethoset receiver

The two-channel and stereo versions of Sennheiser's new stethoset generation operate on the extremely reliable carrier frequencies 2.3 and 2.8 MHz. They are an ideal choice for applications where reproduction quality is paramount, e.g. for stereo music transmissions.

The most versatile of these receivers is the HDI 302, which can be switched between stereo operation and reception on channel 1 or 2. This option is very convenient when you are, for example, planning to set up a high-quality mini interpretation system. You could transmit two translations on channels 1 and 2 and reinforce the floor language via a PA system. The RI 300 product variant is a pure stereo receiver, which cannot be switched between channels.

The HDI 302 and RI 300 are fitted with a squelch which mutes the audio output when the IR signal becomes too weak, thus avoiding loud hiss. The receivers are powered by a BA 151 NiMH accupack which can be charged in the L 151-10 charging unit while remaining in the receivers. Optionally, the L 151-10 also charges spare accupacks instead of an entire receiver. The charging unit is powered by an NT 92 plug-in mains unit. The L 151-2 charger charges two accupacks and is supplied complete with mains unit. For larger, professional applications, the charging units can be cascaded. Up to five L 151-10 are then powered via an NT 2013 (or NG 2013-UK) plug-in mains unit.

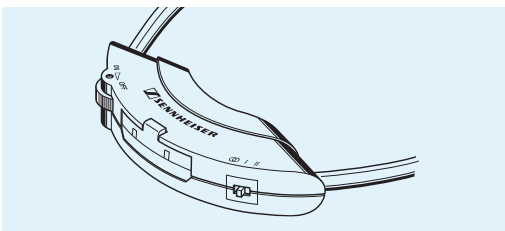

Channel selector switch of the HDI 302

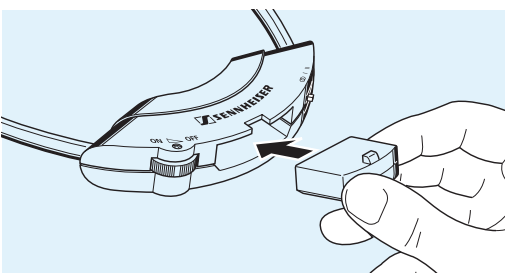

Inserting the BA 151 accupack into the HDI 302

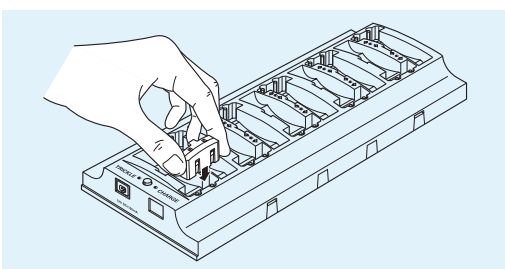

Alternative to charging a complete receiver: charging of a spare accupack in the L 151-10 charging unit